

LE 10XRT

ROOFTOP UNIT



Download specification at:
renewaire.com/specifications

Energy Recovery Ventilator Standard



SPECIFICATIONS

Ventilation Type:
Static plate, heat and humidity transfer

Typical Airflow Range: 2,500-11,000 CFM

AHRI 1060 Certified Core: Ten L125-G5

Standard Features:
TEFC Premium efficiency motors
Motor starters
Non-fused disconnect
24 VAC transformer/relay package
Rubber vibration isolators
Cross-core differential pressure ports

Filters:
Total qty. 20, MERV 8: 20" x 25" x 2"

Unit Dimensions & Weight:
111 1/4" L x 205 1/2" W x 71 1/4" H
Modular (per module) 1,493-2,057 lbs., varies by option(s)
Assembled (1-piece) 3,032-3,993 lbs., varies by option(s)

Max. Shipping Dimensions & Weight (on pallet):
Modular (2-modules) 120" L x 90" W x 78" H
Module 1 - 2,277 lbs., Module 2 - 2,245 lbs.
Assembled (1-piece) 240" L x 90" W x 78" H - 4,433 lbs.

Motor(s):
Qty. 2, Belt drive blower/standard motor packages with choice of adjustable sheaves for low, medium or high blower speed. (see table below)

Options:
Spring vibration isolators
Onboard variable frequency drives (VFDs) - one or both airstreams
Shaft grounding ring on motors with VFDs
Fused disconnect
Integrated programmable controls - enhanced, premium
Class 1 low leakage motorized isolation dampers - OA, RA or both
Qty. 2, Factory mounted filter alarms - both airstreams
Double wall construction
Exterior paint - white, custom colors

Accessories:
Filters - MERV 13, 2" or 4"; MERV 8, 4" (shipped loose)
Roof curb - standard 14"
Curb wind clip
Digital time clock - wall mount (TC7D-W), in exterior enclosure (TC7D-E)
Carbon dioxide sensor/control - wall mount (CO2-W), duct mount (CO2-D)
IAQ sensor - wall mount (IAQ-W), duct mount (IAQ-D)
Motion occupancy sensor/control - ceiling mount (MC-C), wall mount (MC-W)
Smoke Detector - duct mount (SD-D)
Electric duct heater - EK series (1-175 kW); designed for indoor ductwork installation only
Indirect gas-fired duct furnace - GH series (50-400 MBH), installed downstream of any fans

AIRFLOW PERFORMANCE

Airflow CFM	External Static Pressure (in.w.g.)																		
	0.00		0.25		0.50		0.75		1.00		1.25		1.50		1.75		2.00		
	BHP	RPM	BHP	RPM	BHP	RPM	BHP	RPM	BHP	RPM	BHP	RPM	BHP	RPM	BHP	RPM	BHP	RPM	
	3 HP LOW SPEED																		
2500					1.0	640	1.2	740	1.5	820	1.7	880	2.0	950	2.3	1000	2.6	1060	
3000					1.1	660	1.4	760	1.7	830	2.0	900	2.3	960	2.6	1020	2.9	1070	
3500					1.3	690	1.6	770	1.9	850	2.2	920	2.5	980	2.9	1040	3.2	1090	
4000					1.5	710	1.8	790	2.1	870	2.5	930	2.8	1000	3.2	1060	3.6	1110	
4500			1.4	650	1.7	740	2.1	810	2.4	890	2.8	950	3.2	1020	3.6	1070	3.9	1130	
5000			1.7	680	2.0	760	2.4	840	2.7	910	3.1	970	3.5	1030	3.9	1090	4.4	1150	
5500			2.0	720	2.4	800	2.7	870	3.1	930	3.5	990	3.9	1050	4.4	1110	4.8	1170	
6000	3 HP LOW SPEED	1.7	650	2.0	720	2.4	800	2.7	870	3.1	930	3.5	990	3.9	1050	4.4	1110	4.8	1170
6500		2.1	690	2.4	760	2.8	830	3.1	890	3.5	960	4.0	1020	4.4	1080	4.8	1130	5.3	1190
7000		2.5	740	2.8	800	3.2	870	3.6	930	4.0	980	4.4	1040	4.9	1100	5.3	1160	5.8	1210
7500	5 HP LOW SPEED	3.0	790	3.3	850	3.7	900	4.1	960	4.5	1010	5.0	1070	5.4	1120	5.9	1180	6.4	1230
8000		3.5	840	3.9	890	4.3	940	4.7	990	5.1	1040	5.5	1100	6.0	1150	6.4	1200	6.9	1250
8500	5 HP MED SPEED	4.1	880	4.5	930	4.9	980	5.3	1030	5.7	1070	6.1	1120	6.6	1170	7.0	1220	7.5	1270
9000	7.5 HP LOW SPEED	4.8	930	5.2	970	5.5	1010	5.9	1060	6.3	1100	6.8	1150	7.2	1200	7.7	1240	8.1	1290
9500		5.5	970	5.9	1010	6.2	1050	6.6	1090	7.0	1130	7.4	1170	7.8	1220	8.3	1260	8.7	1300
10000	7.5 HP MED SPEED	6.2	1010	6.6	1050	6.9	1080	7.3	1120	7.7	1160	8.1	1200	8.5	1240	8.9	1280	9.3	1310
10500		7.0	1050	7.3	1080	7.7	1110	8.0	1150	8.4	1180	8.7	1220	9.1	1250	9.5	1290	9.9	1320
11000		7.8	1080	8.1	1110	8.4	1140	8.7	1170	9.1	1200	9.4	1230	9.7	1260				
		8.6	1110	8.9	1140	9.2	1160	9.4	1190	9.7	1220								
		10 HP MED SPEED				10 HP HIGH SPEED													

Note: Airflow performance includes effect of clean, standard filter supplied with unit.

ELECTRICAL DATA

Standard Electrical Specifications							Optional Factory Installed VFD Electrical Specifications		
HP	Volts	HZ	Phase	FLA per motor	Min. Cir. Amps	Max. Overcurrent Protection Device	FLA per motor	Min. Cir. Amps	Max. Overcurrent Protection Device
3.0	208-230	60	Single	14.7-14	33.1	40	9.38-8.48	40.2	45
3.0	208-230	60	Three	9.38-8.48	21.1	25	9.38-8.48	23.2	25
	460	60	Three	4.24	9.5	15	4.24	10.5	15
	575	60	Three	3.3	7.4	15	3.3	8.2	15
5.0	208-230	60	Three	14.5-13.4	32.6	45	14.5-13.4	35.9	45
	460	60	Three	6.7	15.1	20	6.7	16.6	20
	575	60	Three	5.3	11.9	15	5.3	13.1	15
7.5	208-230	60	Three	21.0-19.0	47.3	60	21.0-19.0	52.0	60
	460	60	Three	9.5	21.4	25	9.5	23.5	25
	575	60	Three	7.6	17.1	20	7.6	18.8	20
10.0	208-230	60	Three	27.0-24.4	60.8	80	27.0-24.4	66.8	80
	460	60	Three	12.2	27.5	35	12.2	30.2	35
	575	60	Three	9.76	22.0	30	9.76	24.2	30

CORE PERFORMANCE

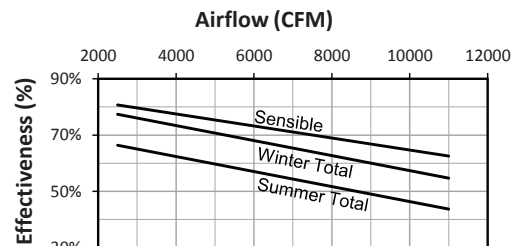

At AHRI 1060 standard conditions.
See all AHRI certified ratings at www.ahrinet.org.

Specifications may be subject to change without notice.



LE10XRT (RTH/RTF) Energy Recovery Ventilator Standard

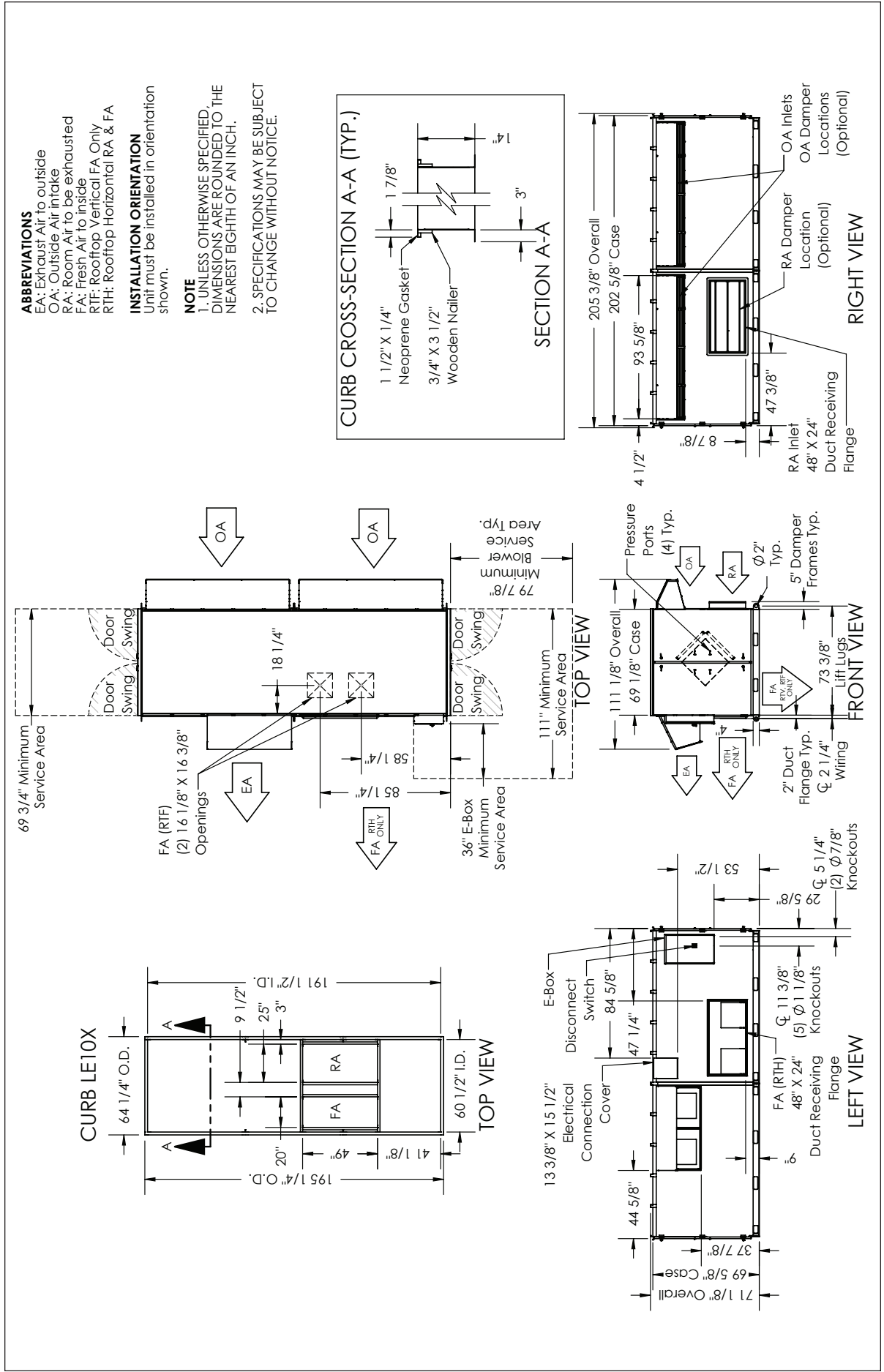

UNIT MOUNTING & APPLICATION
 Must be mounted as shown. Airstreams can not be switched.

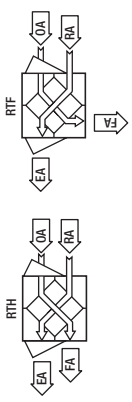

AIRFLOW CONFIGURATION
 Available as shown: