

DUCT SUPPORT DIMENSIONS
WIDTH: 1 1/2" DEPTH: 3"

DN5RT
CURB DN5-ERV+C+H

RA: Room Air to be exhausted
SA: Supply Air to inside

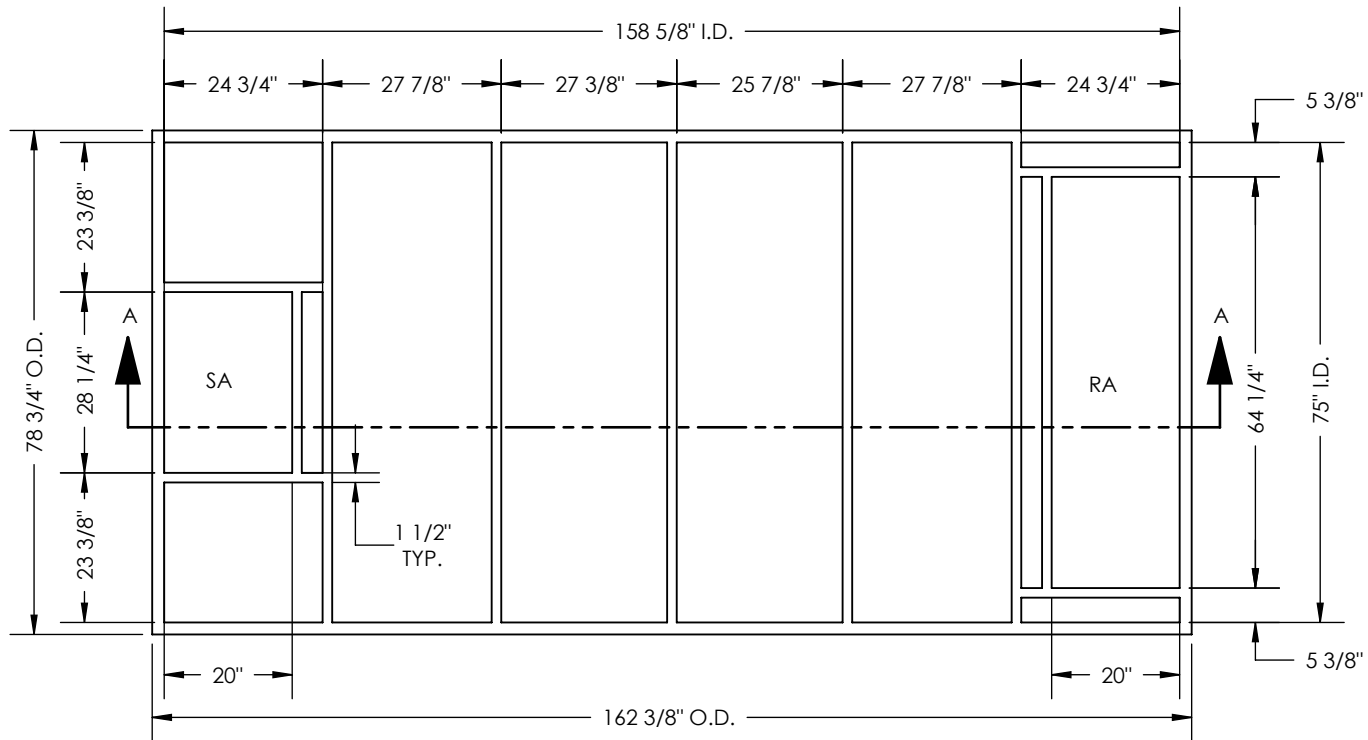

TOP VIEW

END VIEW

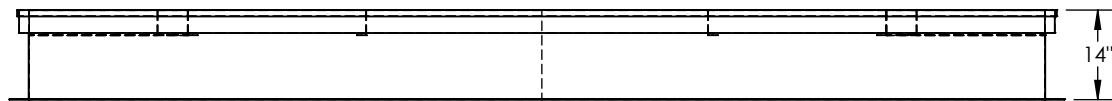

FRONT VIEW

CURB CROSS-SECTION A-A (TYP.)

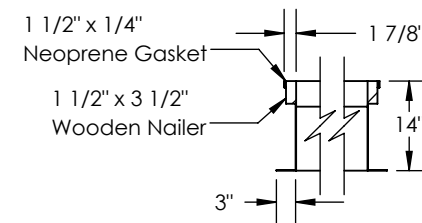

SECTION A-A