

# EV 200

## INDOOR UNIT



**Note:** There are multiple control options designed to address individual climate conditions. Please consult your local installer for the best installation controls for your climate.

## ENERGY RECOVERY VENTILATOR



### SPECIFICATIONS

#### Ventilation Type:

Static plate, heat and humidity transfer

**Typical Airflow Range:** 100–200 CFM

#### Unit is HVI Tested/Certified per CSA C439 Protocol:

Using one L-100-G5 Core

#### Standard Features:

White painted cabinet  
Line-cord power supply  
Low-voltage circuit for controls  
Unit may be mounted in any orientation  
Cross-core differential pressure ports

**Controls:** Onboard 24VAC transformer/relay package

#### Filters:

Total qty. 2, MERV 8, spun-polyester media:  
10 1/2" x 21 3/4" x 1"

**Unit Weight:** 68 lbs.

#### Max. Shipping Dimensions & Weight (on pallet):

34" L x 44" W x 34" H  
110 lbs.

**Units Per Pallet:** 4

#### Motor(s):

Qty. 1, Double-shaft standard motor

#### Accessories:

Backdraft damper: 6", 8"  
Automatic balancing damper: 4", 5", 6"  
Motorized Dampers: 6", 8"  
Louvered wall vent 6": white, brown  
Louvered wall vent 8": taupe vinyl, galvanized, paintable galvanized  
Louvered wall vent with 8" round duct connection: 12" W x 8" H  
Hooded wall vent 8": galvanized, paintable galvanized  
Digital time clock: wall mount (TC7D-W), in exterior enclosure (TC7D-E)  
Carbon dioxide sensor/control: wall mount (CO2-W), duct mount (CO2-D)  
IAQ sensor: wall mount (IAQ-W), duct mount (IAQ-D)  
Motion occupancy sensor/control: ceiling mount (MC-C), wall mount (MC-W)  
Percentage timer control (PTL)  
Push-button point-of-use controls (PBL), PTL req'd.  
Percentage timer control with furnace interlock (FM)  
MERV 13 filter: OA airstream (shipped loose)  
Electric duct heater: RH series (1–6 kW); designed for indoor ductwork installation only

### ELECTRICAL DATA

HP	Volts	Hz	Phase	Watts	FLA
0.1	120	60	Single	157 @ 181 CFM	1.5

### UNIT PERFORMANCE

Airflow (CFM)	External Static Pressure (Inches Water Column)
95	0.80
131	0.70
157	0.60
172	0.50
182	0.40
189	0.30
195	0.20
206	0.10

### CORE PERFORMANCE

Airflow (CFM)	Temp EFF%	Total EFF% Winter/Summer
95	83	79/68
131	80	76/64
157	79	74/62
172	78	73/61
182	77	72/60
189	77	71/59
195	76	71/59
206	76	70/58

**Note:** These are core-only ratings and are not HVI certified. Total EFF% calculated at 35/33wb OA and 70/58wb RA (winter) and 98/78wb OA and 75/63wb RA (summer). HVI ratings apply to complete units only. This unit is HVI certified. See HVI certified ratings on pg. 48 of Single/Multi-Family Catalog and at hvi.org.

### UNIT DIMENSIONS



#### AIRFLOW ORIENTATION

Available as shown in dimension drawing.



#### UNIT MOUNTING & APPLICATION

Can be mounted in any orientation.  
RA/EA airstream can be switched with OA/SA airstream.

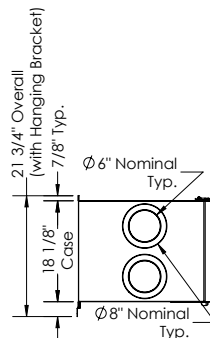

LEFT VIEW

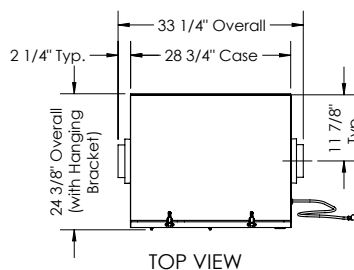

TOP VIEW

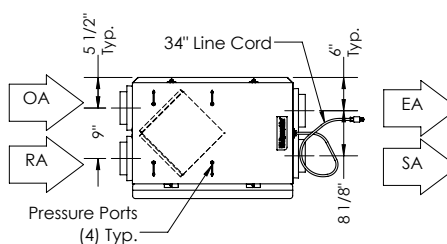

FRONT VIEW

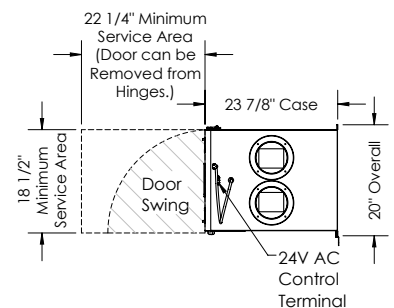

RIGHT VIEW

#### ABBREVIATIONS

EA: Exhaust Air to outside  
OA: Outside Air Intake  
RA: Room Air to be exhausted  
SA: Supply Air to inside

#### INSTALLATION ORIENTATION

Unit may be installed in any orientation.

#### NOTE

1. UNLESS OTHERWISE SPECIFIED, DIMENSIONS ARE ROUNDED TO THE NEAREST EIGHTH OF AN INCH.

2. SPECIFICATIONS MAY BE SUBJECT TO CHANGE WITHOUT NOTICE.